

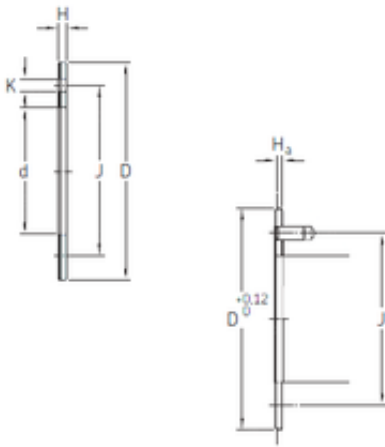

BEARING-MALAYSIA SDN.BHD.



SKF PCMW 284801.5 E plain bearings

Bearing No. PCMW 284801.5 E

PCMW 284801.5 E Bearing 2D drawings and 3D CAD models

Size	28x48x1.5 mm
Bore Diameter	28 mm
Outer Diameter	48 mm
Width	1,5 mm
d	28 mm
D	48 mm
H	1,5 mm
J	38 mm
K	4,25 mm
Ha min.	1 mm
Weight	0,013 Kg
Basic dynamic load rating (C)	93 kN
D _a	48 mm
J _a	38 mm
H _a	1 mm
Basic dynamic load rating - radial direction C	93 kN
Basic static load rating - radial direction C ₀	290 kN
Specific dynamic load factor K	80 N/mm ²
Specific static load factor K ₀	250 N/mm ²
Factor depending on material and bearing type K _M	300
Permissible sliding velocity v max.	2 m/s



BEARING-MALAYSIA SDN.BHD.

Permissible sliding velocity v min.	0 m/s
Coefficient of friction μ max.	0.25
Coefficient of friction μ min.	0.03
Mass thrust washer	0.013 kg